

MAINTENANCE AND CARE

- Brace should be worn over a cotton shirt.
- Fold the brace and attach the handle near the patient's lateral midline.
- Hand wash in warm water, towel off, and air dry in shade. Do not use any substances containing chlorine.

AT THE END OF ITS USE LIFE, DISCARD IT ALONG WITH YOUR NORMAL WASTE

INDICATIONS

- Burst FX
- Post-Op Spinal Lumbar Instability
- Post-Op Disc Surgery
- Post-Op Laminectomy
- Kyphosis
- Scoliosis
- Paraplegic
- Cerebral Palsy
- Degenerative, Herniated or Bulging Disc
- Spondylolysis
- Spondylolisthesis
- Facet Syndrome

- Spinal Stenosis
- Tumors or Inflammation
- Chronic back pain
- Spinal Instability

And other conditions determined by an orthopedic surgeon, orthotist or other healthcare professional

Subscribe to our Fitting instructions videos on YouTube at:
www.youtube.com/OPTECUSA

OPTEC USA

975 Progress Circle Lawrenceville GA 30043
 International
 Ph: 1.770.513.7380 • F: 1.770.513.4365
 Ph: 888.982.8181 • F: 877.288.4197
 Email: sales@optecusa.com



www.optecusa.com

TLSO w/ DLK



FITTING INSTRUCTIONS



The Venum™ 1 TLSO acts as an immobilizing device for the thoracic-lumbar-sacral region. Its primary function is to reduce pain and provide support to the thoracic-lumbar-sacral spine. *See indications on the other side. This brace is ideal for patients requiring firm spinal support. The Venum™ 1's one-size-fits-all design comfortably fits sizes Small - 3X-Large without compromising effectiveness and reduces inventory stock. With its unique and mechanically advanced single drawstring pulley system closure, the Venum™ 1 TLSO makes it easy to don & doff with minimal effort. Its sleek weightless construction is breathable, hypoallergenic and nearly undetectable under clothing. The Venum™ 1 TLSO's rigid panels contour to your patient's lordotic curve and abdomen resulting in comfort, control and increased compliance.

SIDE EFFECTS AND WARNINGS

Assuming that the products are used according to instructions and given that they are not invasive, there are no side effects affecting the organism as a whole. All braces and supports, if too tight, can cause discomfort due to compression. If you observe any change in your general state or deterioration of your condition, please consult your doctor. During prolonged periods, it is recommended to reduce the tension on your device until you resume normal activities where you will reset the tension to the original level recommended to you. Any modifications of these products will result in the annulment of the warranty along with the denial of any responsibilities on our behalf.

1 VENUM™ 1 TLSO W/ DLK

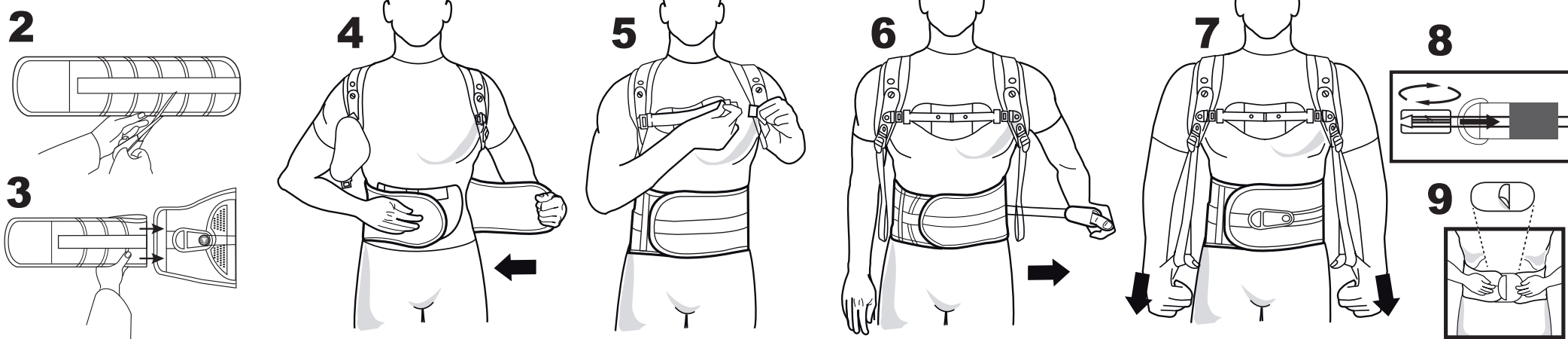
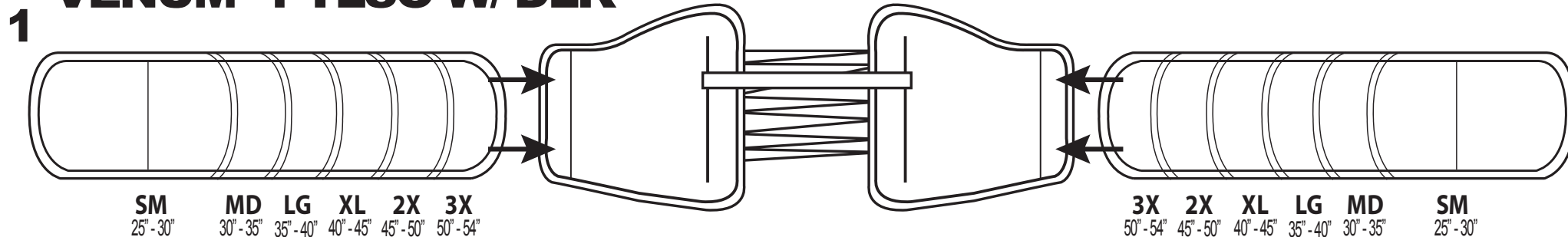

1 - Venum 1 Corset Sizing

a) To adjust the flaps to the desired length, first identify the correct sizing section for the waist circumference as shown in Figure 1.

b) Remove each flap from the corset pocket and fold each flap along the outer edges of the desired sizing section (SM-3X) as indicated by the red stitching.

Note: It is suggested that the flaps are folded along the outer edge of the desired section during the initial fitting to ensure the correct length is chosen. For smaller waist circumferences, the ends of the flaps may have to be folded over more than once to fit inside the pocket. Once the flap length is confirmed, the flap may be trimmed with scissors along the outer edge of the red lines for that size as shown in Figure 2.

c) Insert each flap into the corset pockets and smooth the pockets down over each flap to secure them in place as shown in Figure 3. The flap covered in hook material on the back should be on the left side and the flap with loop material on the back should be on the right side.

2 - Placement and Adjustment

a) With the Venum 1 TLSO corset open and the sternal panel attached to the right side only, slip your arms through the loops of the DLK as if putting on a backpack. Your caregiver should have already adjusted the DLK and the position of the right front floating panel specifically to the appropriate settings for your body.

b) With the posterior plastic panel centered on your back, hold the right abdominal flap firmly with the right hand over the abdomen. Grasp the left flap with the left hand and stretch the flap outwards. Next, wrap the left flap around the body using the Velcro ends to secure the left flap over the right flap as shown in Figures 4 and 5.

c) Snap the left side of the sternal panel into the other side of the buckle as shown in Figure 5.

3 - Tighten

a) Pull the handle to the desired position. When the appropriate amount of tension is reached, place the hook backed handle down onto the brace to secure the fit as shown in Figures 6 and 7.

4 - DLK Adjustment

a) Pull the handle to the desired position. To shorten the cord length, remove the clip from the back pocket of the handle and wrap the cord through the clip loop until the desired length is achieved and place the clip back into the pocket. When the appropriate amount of tension is reached, place the hook backed handle down onto the brace to secure the fit as shown. (See Figures 6, 7 and 8)

5 - Optional Extender: To add an additional 6" to the waist circumference with the extender, apply the attachment by peeling the outer flap to expose the hook Velcro on the back creating a pocket for the corset. Align the right front panel over the loop material at the edge of the flap and smooth the flap down to secure the panel. (Figure 9)

Extender Panel for patients above 54"

HOW TO FIT



To apply it correctly,
follow these instructions:

Warranty: OPTEC USA products are warranted for free repair or replacement due to manufacturer's defects within 90 days of the date of purchase or the date fitted.